

I-2015



12/8/05
12/8/05
12/8/05

APPROVED

PLAN No. P/6/4/11/05
R3/CB/12/13/05
APN: 13/7/2005

Structural Safety Should be
Ensured by the Party

Foundation provided under all columns
as per A.M. No. 10 of 1957 or as per IS 10134
as applicable with 300mm concrete
rafters and 100mm concrete
bedding under all columns.

SCHEDULE OF DOORS AND WINDOWS:

TYPE	WIDTH	HEIGHT	NOS. IN G.F.L.	NOS. IN F.F.L.	NOS. IN S.F.L.	SPECIFICATION
D1	1050	2100	24	24	24	FLUSH DOOR
D2	1800	2400	17	17	17	PANELLED DOOR
D3	750	2100	10	10	10	FLUSH DOOR
D4	1200	2400				PANELLED DOOR
W1	1000	1650	17	17	17	GLAZED STEEL WINDOW
W2	1200	1650	3	3	3	-do-
W3	1500	1650	2	2	2	-do-
W4	1800	1650	51	51	51	-do-
W5	2000	1650				-do-
W6	2400	1650	7	7	7	-do-
W7	2700	1650	5	5	5	-do-
W8	1000	1000	2	2	2	-do-
W9	750	600	10	10	10	-do-

LEGEND

- 1 CLASS ROOM
- 2 LABORATORY
- 3 HOD'S OFFICE
- 4 HOD'S ROOM
- 5 TEACHER'S ROOM
- 6 GENTS' TOILET
- 7 LADIES' TOILET
- 8 MACHINE LAB
- 9 CHEMISTRY LAB
- 10 APPLIED MECHANICS LAB
- 11 PHYSICS LAB
- 12 DRINKING WATER
- 13 LIFT.

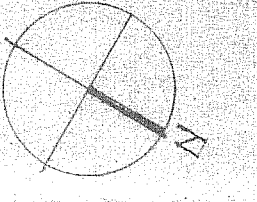
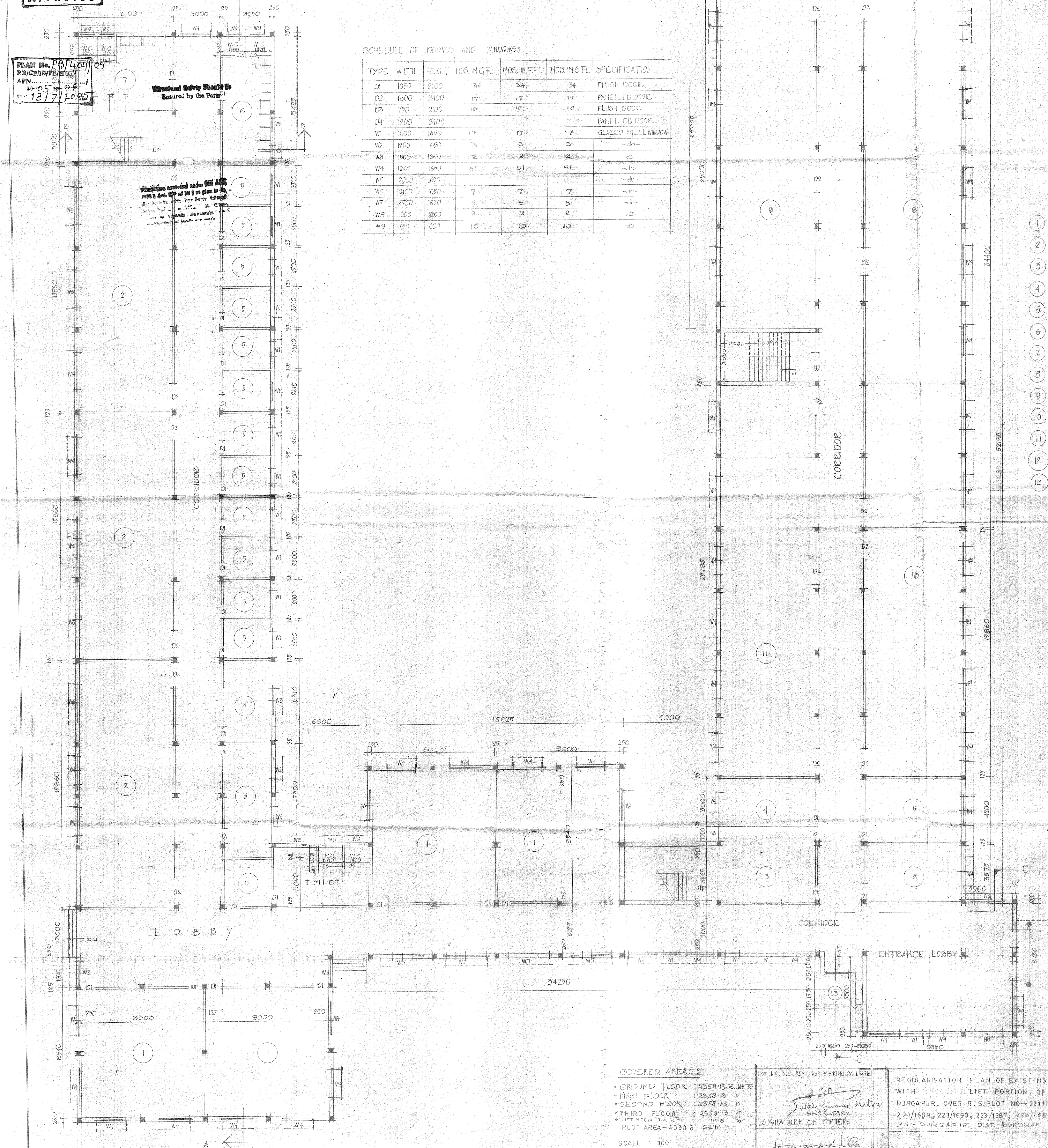

GROUND FLOOR PLAN
SHEET NO - 1

COVERED AREAS :

- GROUND FLOOR : 2358.13 SQ. METRE
- FIRST FLOOR : 2358.13 "
- SECOND FLOOR : 2358.13 "
- THIRD FLOOR : 2358.13 "
- LIFT ROOM AT 4TH FL. : 14.57 "
- PLOT AREA - 4090.8 SQ.M

SCALE 1:100

ALL DIMENSIONS ARE IN MM.

FOR DR. B.C. ROY ENGINEERING COLLEGE

Dulal Kumar Mitra
SECRETARY
SIGNATURE OF OWNERS

HARISHNA MAITRA
LIC NO. 0176/1992/52
SIGNATURE OF ENGINEERS
REC'D: 18-07-05 DATE: 27/06/05

REGULARISATION PLAN OF EXISTING FOUR STORED MAIN BUILDING WITH LIFT PORTION OF DR. B.C. ROY ENGINEERING COLLEGE, DURGAPUR, OVER R. S. PLOT NO - 221 (P), 222, 223, 235, 236, 239, 246 (P), 223/1689, 223/1690, 223/1687, 223/1688 OF MOUZA - FULSHORE, PIN - 721002, R.S. - DURGAPUR, DIST. BURDWAN WARD NO. 25

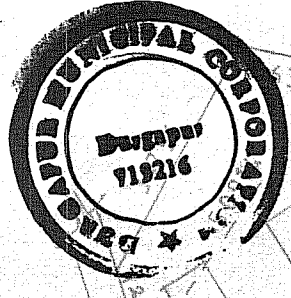

APPROVED

PLAN No. 404/0
 RB/CB/IB/PB/MT/
 APN.....
 19-05-19-06
 Date: 13/7/2005

[Handwritten signatures and stamps]
 Municipal Engineer
 Durgapur Municipal Corporation

Structural Safety should be
 Ensured by the Party

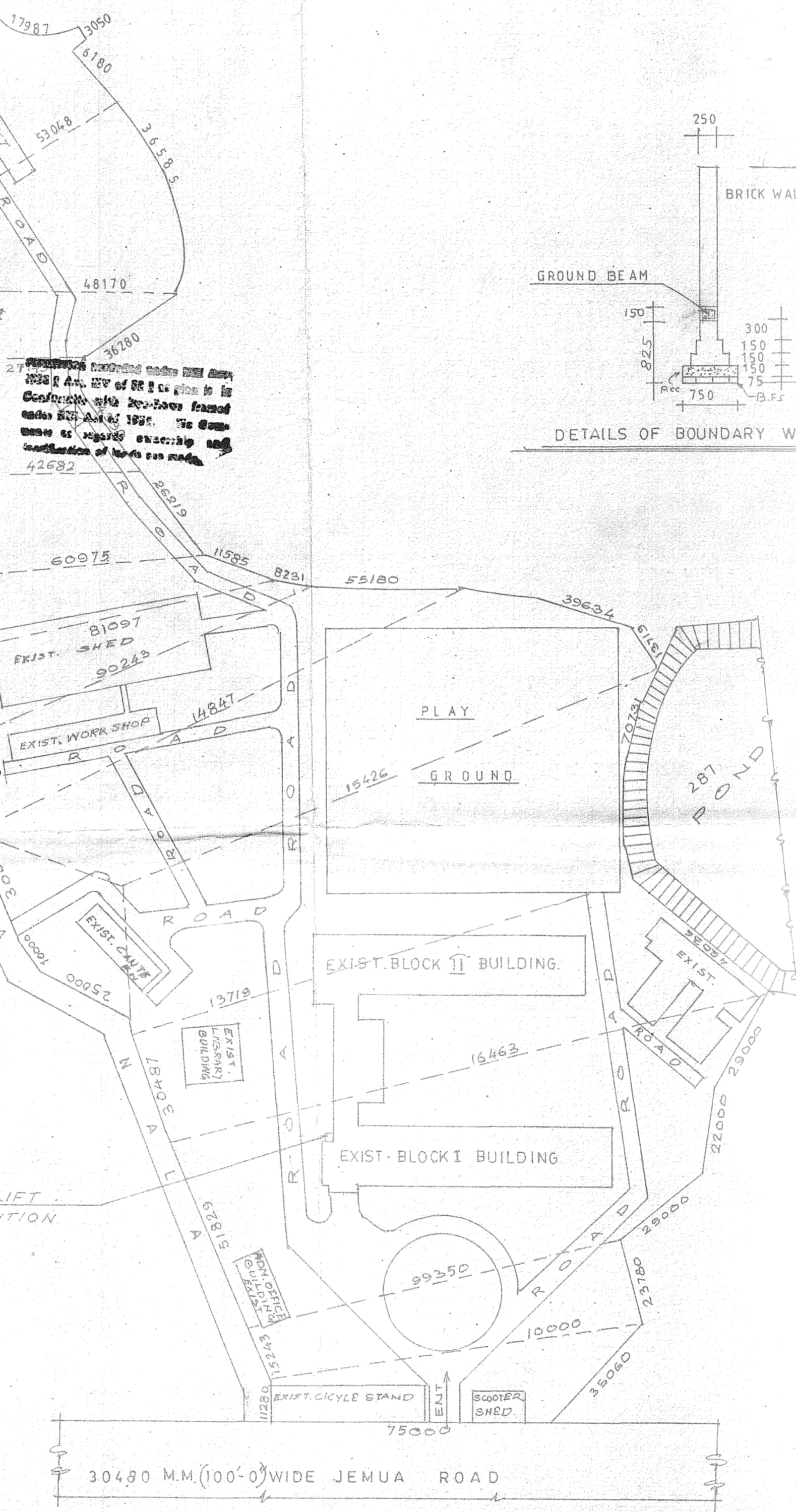

30480 M.M (100'-0") WIDE JEMUA ROAD

SITE PLAN

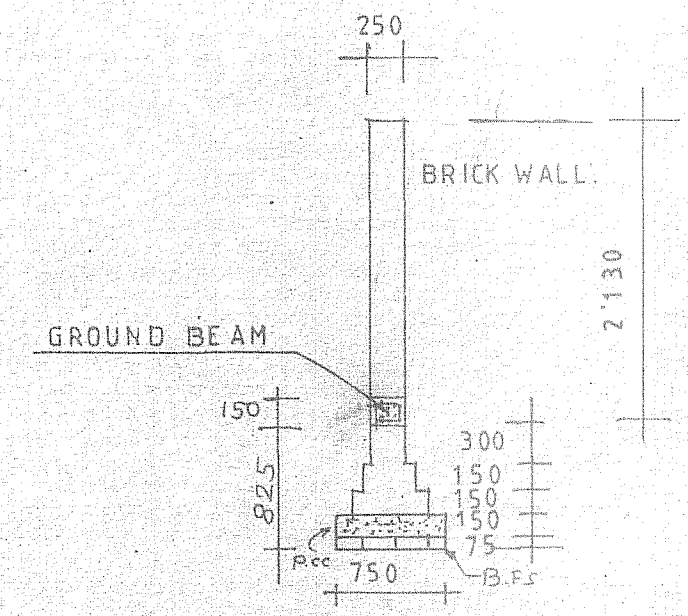

DETAILS OF BOUNDARY WALL FOUNDATION

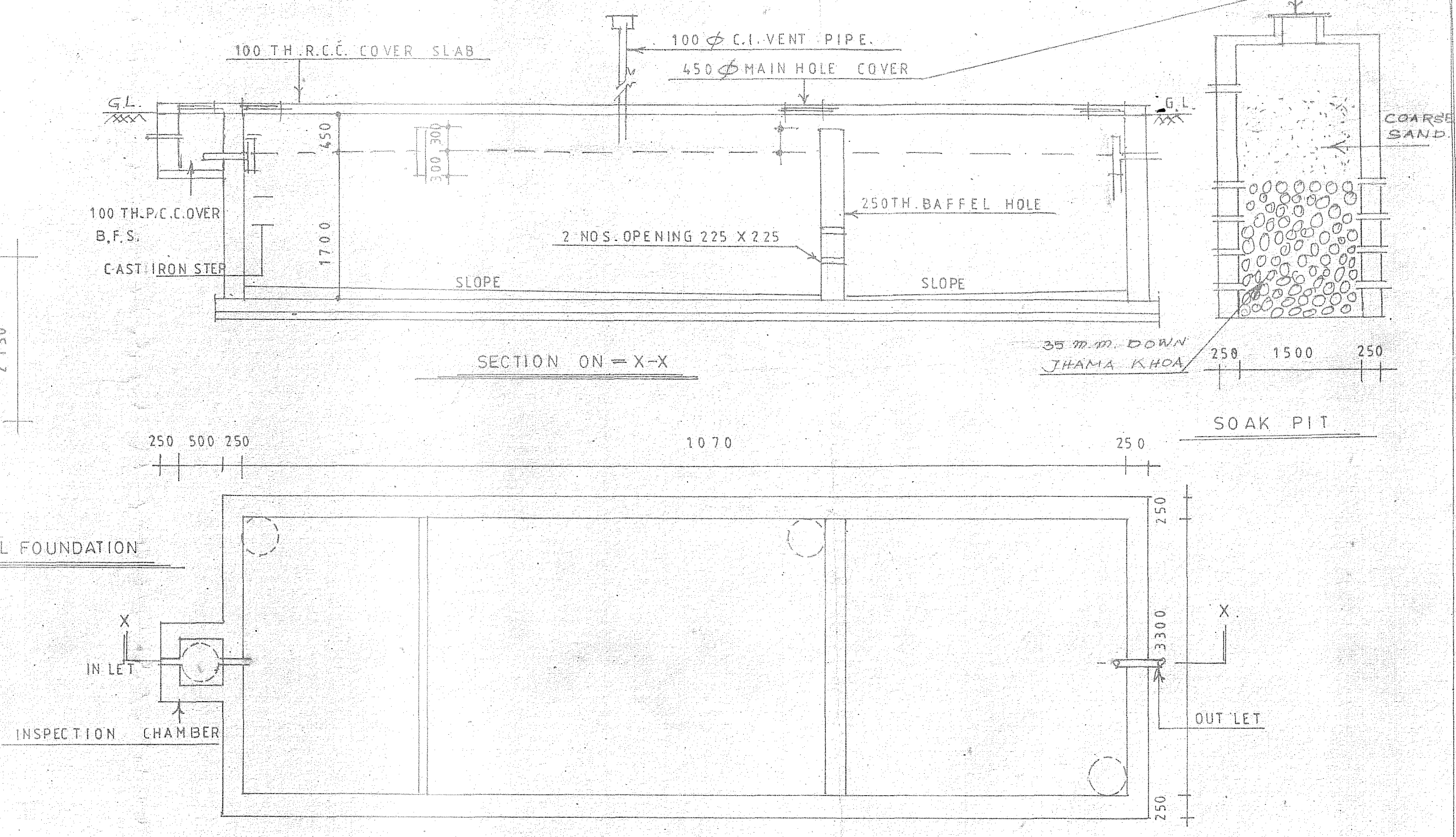

PLAN DETAILS OF SEPTIC TANK FOR 300 PERSON.

**SITE PLAN
 & SEPTIC TANK DETAILS**

SHEET NO.
6
 SIX

REGULARISATION PLAN OF EXISTING FOUR STORED MAIN BUILDING WITH LIFT PORTION OF DR. B.C. ROY ENGINEERING COLLEGE, DURGAPUR, OVER R.S. PLOT NO. 221(P) 222, 223, 235, 236, 295, 296 (P), 223/1689, 223/1690, 223/1687, 223/1688 OF MOUZA - FULJHORE, J.L. NO-82, P.S. DURGAPUR, DIST. BURDWAN.

LAND AREA — 4090.8 SQ.M.	SCALE 1:1000, 1:50,	
GROUND FLOOR — 2358.13 SQ.M	FOR DR. B.C. ROY ENGINEERING COLLEGE,	SIGNATURE OF ENGINEER,
FIRST FLOOR — 2358.13 SQ.M	<i>[Signature]</i> Jugal Kumar Mitra SECRETARY	<i>[Signature]</i> HAREKRISHNA MAITRA 40 No DMC/BPD/56 DATE 27-06-05
SECOND FLOOR — 2358.13 SQ.M		
THIRD FLOOR — 2358.13 SQ.M		
LIFT ROOM AT 4TH FL 14.51 SQ.M		
ALL DIMENSIONS ARE M.M	SIGNATURE OF OWNER'S	